

ORDINANCE NO. 001-2024

AMENDING THE ZONING MAP ATTACHED TO CHAPTER 1104.01 OF THE 2023 CODIFIED ORDINANCES OF THE CITY OF WHITEHALL, OHIO AND AS SUBSEQUENTLY AMENDED, ALLOWING A SPECIAL PERMIT UNDER SECTION 1104.03(H) TO PERMIT BUY & BUY AUTO SALE, LLC COMPANY TO OPERATE A VEHICLE AND LARGE EQUIPMENT REPAIR BUSINESS IN THE MAIN STREET DISTRICT.

WHEREAS, Council has received an application from Buy & Buy Auto Sale, LLC for a Special Permit to operate a vehicle and large equipment repair business in the Main Street Corridor District; and

WHEREAS, Said request for a Special Permit was referred to the Planning Commission (Case No. 876), which reported _____ on said request; and

WHEREAS, Council has held a Public Hearing after due notice according to law; NOW, THEREFORE,

BE IT ORDAINED BY THE COUNCIL OF THE CITY OF WHITEHALL, OHIO:

SECTION 1: That the Zoning Map attached to Chapter 1104.01 of the 2023 Codified Ordinances for the City of Whitehall, Ohio and as subsequently amended, be and the same is hereby amended by allowing a special permit under 1104.03(H) for the following described premises, to wit:

(SEE PRELIMINARY SITE PLAN ATTACHED OF THE PROPERTY)

SECTION 2: That said Special Permit is granted on the following conditions pursuant to Section 1125.04(H)(1) and Section 1125.04(H)(2) of Codified Ordinances.

1. A special use permit shall automatically expire if the permitted use has not been established or utilized within one year of the date on which the special use permit was issued unless the City Council grants an extension.
2. A special use permit shall automatically expire if for any reason the permitted use ceases operation for more than 12 consecutive months.

SECTION 3: That the Director of Public Service is hereby authorized and directed to proceed with the prescribed Ordinance directing the City Engineer to change the Official Zoning Map of the City of Whitehall.

SECTION 4: That this ordinance shall take effect and be in force from the earliest period allowed by law.

PASSED this ____ day of _____, 2024.

ATTEST:

Clerk of Council

President of Council

APPROVED this ____ day of _____, 2024.

Mayor

Requested by: Applicant

Approved as to form by: Bradley S. Nicodemus, Assistant City Attorney BSN 12/28/2023

Parking

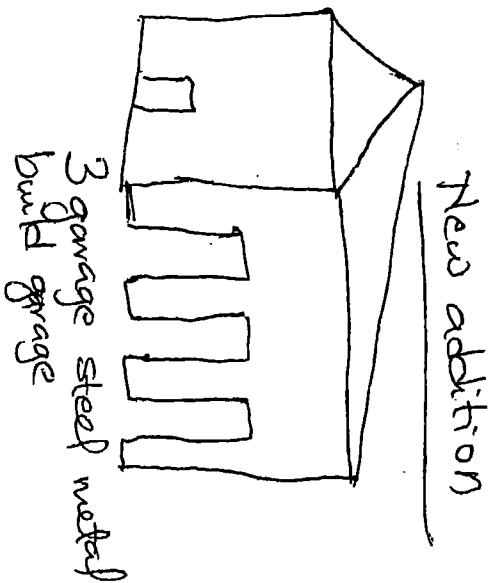
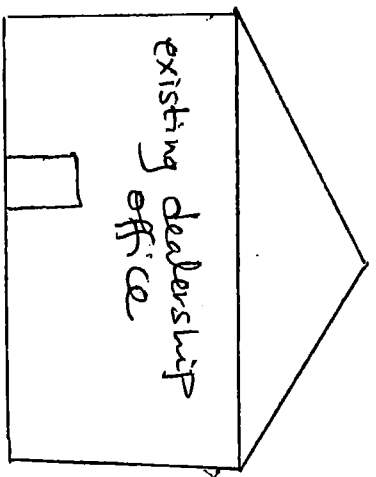

Dealer lot

4333 E Main St

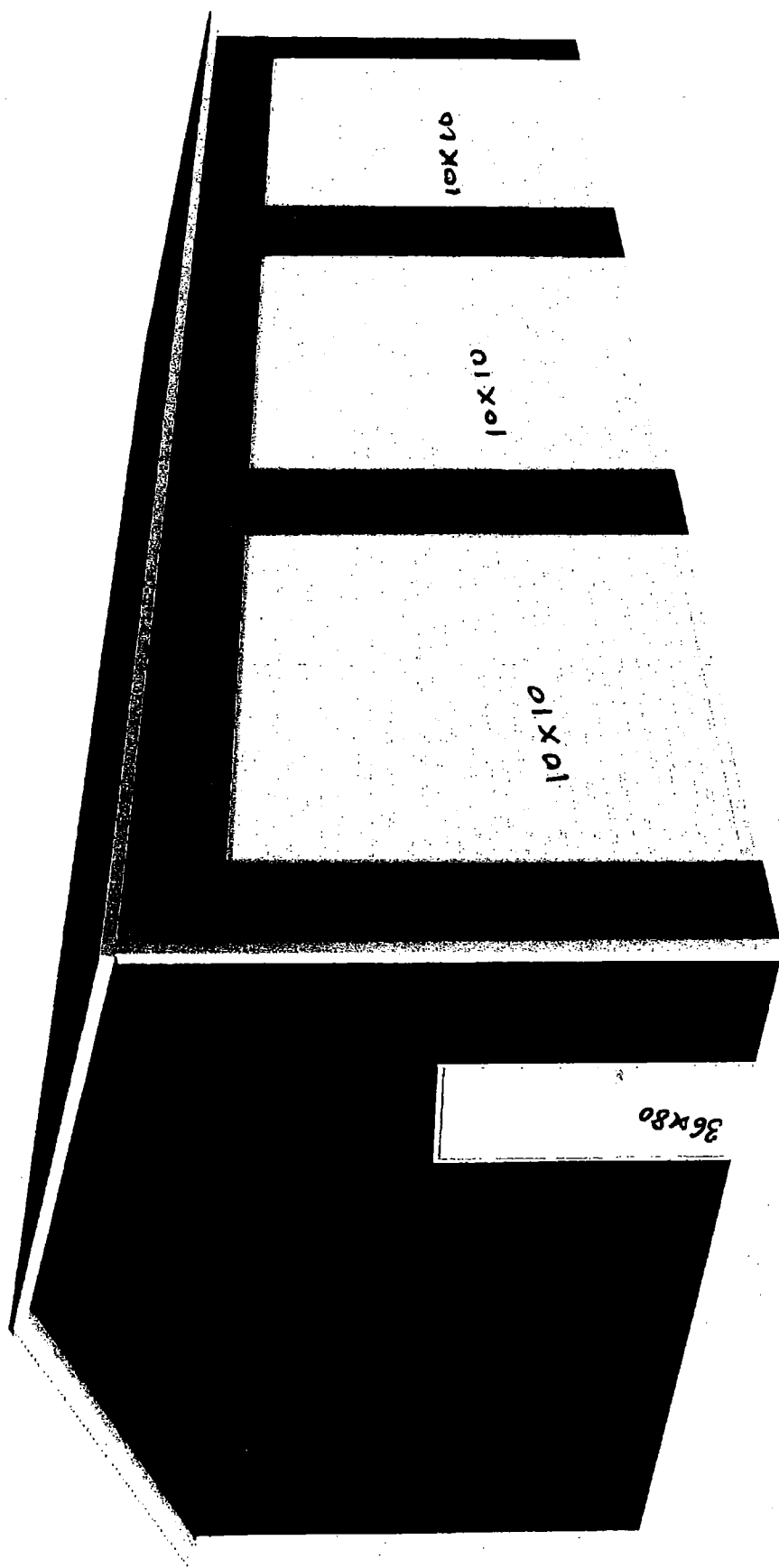

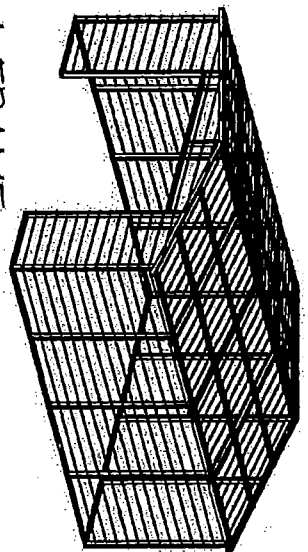
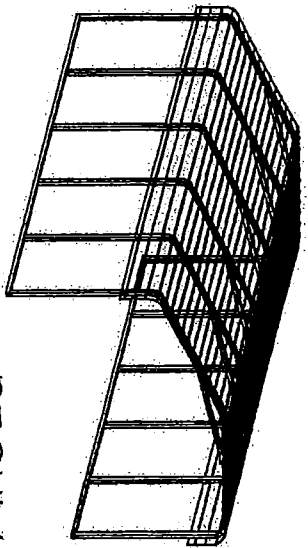

REGULAR / A-FRAME 26'-0" WIDE CARPORT STYLE BUILDINGS

DESIGN NOTES

1. ALL CONSTRUCTION SHALL BE PROVIDED IN ACCORDANCE WITH IBC 2015, ASCE 7-10, ASCE 7-10, AMS D15 CODES AND ALL APPLICABLE LOCAL REQUIREMENTS.
2. ALL MATERIALS IDENTIFIED BY MANUFACTURER NAME MAY BE SUBSTITUTED WITH MATERIAL EQUAL OR EXCEEDING ORIGINAL.
3. ALL SHOP CONNECTIONS SHALL BE WELDED CONNECTIONS.
4. ALL STRUCTURAL FIELD CONNECTIONS SHALL BE #12-14 X 3/4" SD5 (ESR-2196 OR EQ) WITHOUT WASHERS.
5. STEEL SHEATHING SHALL BE 29GA CORRUGATED GALV. OR PAINTED STEEL - MAIN RIB HT. 3/4" (FY=80KSI) OR EQ. CONNECTIONS SHALL BE #12-14 X 3/4" SD5 (ESR-2196 OR EQ) WITH NEOPRENE WASHERS.
6. ALL STRUCTURAL LIGHT GAUGE TUBING AND CHANNELS SHALL BE GRADE 50 STEEL (FY = 50 KSI, FU = 65 KSI).
7. STRUCTURAL TUBE 2 1/2" X 2 1/2" - 14GA. IS EQUIVALENT TO 15.2 1/2" X 2 1/2" - 12GA AND EITHER ONE MAY BE USED IN LIEU OF THE OTHER.
8. GYPSUM BOARD OR DRYWALL FINISH OR ANY BRITTLE BASE MATERIAL IS NOT CONSIDERED OR ACCOUNTED FOR ON THE DESIGN CRITERIA.
9. ALL DESIGN CRITERIA MUST BE INCREASED TO THE NEXT HIGHER INCREMENT BASED ON THE TABLES ON PAGE 4. NO INTERPOLATION IS ALLOWED.

DESIGN CRITERIA

- PREVAILING CODE: 2017 IBC (IBC 2015)
USE GROUP: U (CARPORTS, BARN)
RISK CATEGORY: 1

1. DEAD LOAD (D) D = 4 PSF
2. ROOF LIVE/SNOW LOAD (Lr)
Lr = 20 - 61 PSF
(AS PER SNOW LOAD SEE TABLE 4)

3. SNOW LOAD (S) Sg = 20 - 90 PSF
IMPORTANCE FACTOR Ip = 0.8
THERMAL FACTOR Ct = 12
EXPOSURE FACTOR Ce = 10
ROOF SLOPE FACTOR Cs = 10
WIND LOAD (W)

4. BASIC WIND SPEED Vbr = 105 - 160 MPH
EXPOSURE C
SEISMIC LOAD (E) D
DESIGN CATEGORY D
IMPORTANCE FACTOR Ip = 1.00

- LOAD COMBINATIONS:
1. D + (Lr OR S)
2. D + (0.6W OR ±0.7E)
3. D + 0.75 (0.6W OR ±0.7E) + 0.75 (Lr OR S)
4. 0.6D + (0.6W OR ±0.7E)

DRAWING INDEX

COVER SHEET	1
SCHEDULES & MEMBER SECTIONS	2
FRAME SECTIONS & DETAILS	3
SPACING SCHEDULES - & ENCLOSURE NOTES	4
PURLIN & GIRT SCHEDULES	5
SHEATHING OPTIONS	6
SIDE WALL FRAMING & OPENINGS	7-A, 7-B
END WALL FRAMING & OPENINGS	8-A, 8-B
CORNER BRACING DETAILS	9
OPTIONAL LEAN-TO ADDITION	10
FOUNDATION OPTIONS	11-A TO 11-D

CUSTOMER INFORMATION

OWNER:
ADDRESS:

DESIGN LOADS

GROUND SNOW:
ROOF LIVE LOAD:
BASIC WIND SPEED:

BUILDING INFORMATION

WIDTH:
LENGTH:
HEIGHT:

FRAME TYPE:
☐ A-FRAME
☐ REGULAR
☐ FULL
☐ PARTIAL
☐ OPEN

CERTIFICATION VALIDITY NOTICE

DATE OF PLANS: 01-26-2024
EXPIRATION: 01-26-2024
CERTIFICATION ON THESE DRAWINGS IS VALID FOR ONE YEAR FROM DATE OF ISSUE

MANUFACTURED BY:



457 N. Broadway,
Joshua, TX 76058
1-866-730-9865

ENGINEERED BY:



A&A ENGINEERING
CIVIL - STRUCTURAL
6035 Renaissance Place, Toledo, OH 43623
TEL: 419-292-1583 • FAX: 419-292-0855
www.a-a-engineers.com

DRAWING INFORMATION

PROJECT: 26'-0" WIDE BUILDINGS
LOCATION: STATE OF OHIO
PROJECT NO.: 033-23-0120
SHEET TITLE:

COVER SHEET

SHEET NO.: 1 / 11
DRAWN BY: AW DATE: 1/24/22
CHECKED BY: OAA DATE: 1/24/22

LEGAL INFORMATION

- ANY DUPLICATION OF THIS DRAWING IN WHOLE OR PART IS STRICTLY FORBIDDEN. ANYONE DOING SO WILL BE PROSECUTED UNDER THE FULL EXTENT OF THE LAW.
- DRAWINGS VALID UP TO DATE OF EXPIRATION.

SEAL:

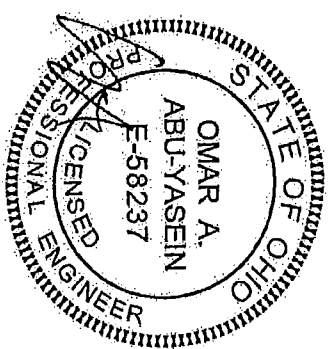

STAMP EXPIRY: 12-31-2023
DATE SIGNED: 01-26-2023

NO.	LABEL	PROPERTY	DETAIL NO.
1	COLUMN POST	2.5" X 2.5" X 14GA TUBE W/ 2.25" X 2.25" X 12GA TUBE INSERT	11
2	ROOF BEAM	2.5" X 2.5" X 14GA TUBE	1
3	BASE RAIL	2.5" X 2.5" X 14GA TUBE	1
4	PEAK BRACE	2.5" X 2.5" X 14GA TUBE	1
5	KNEE BRACES	2.5" X 1.5" X 14GA CHANNEL	4
6	CONNECTOR SLERVE	2.25" X 2.25" X 12GA TUBE	2
7	BASE ANGLE	2" X 2" X 3" LG. 3/16" ANGLE	10
8	PURLIN	4.25" X 1.5" X 18GA / 14GA HAT CHANNEL	5
9	GIRT	4.25" X 1.5" X 18GA / 14GA HAT CHANNEL	5
10	SHEATHING	29 GA CORRUGATED SHEET	8
11	END WALL POST	2.5" X 2.5" X 14GA TUBE	1
12	DOOR POST	2.5" X 2.5" X 14GA TUBE	1
13	SINGLE HEADER	2.5" X 2.5" X 14GA TUBE	1
14	DOUBLE HEADER	DBL 2.5" X 2.5" X 14GA TUBE	1
15	SERVICE DOOR / WINDOW FRAMING	2.5" X 2.5" X 14GA TUBE	1
16	ANGLE BRACKET	2" X 2" X 2" LG. 14GA ANGLE	7
17	STRAIGHT BRACKET	2" X 2" X 4" LG. 14GA PLATE	6
18	PB SUPPORT	2.5" X 2.5" X 14GA TUBE	1
19	DIAGONAL BRACE	2" X 2" X 14 GA TUBE	3
20	GABLE BRACE	2" X 2" X 14 GA TUBE	3
21	DB BRACKET	2.25" X 2.25" X 6" X 14GA ANGLE	9
22	TRUSS SPACER	2.5" X 2.5" X 14GA TUBE	1
23	ALL FASTENERS	#12 X 1" SELF-DRILL SCREWS (ESR-2196 OR EQ W/ NEOPRENE/STEEL WASHER	

TABLE 2.2: SHEATHING FASTENER SCHEDULE

LOCATION	CORNER PANELS	SIDE LAPS	EDGE LAPS	ELSEWHERE
SPACING	9" C/C	MIN 1	4 1/2" C/C	9" C/C

FASTENER TYPE: #12X1" SELF-DRILL SCREWS (ESR-2196 OR EQ W/ NEOPRENE/STEEL WASHER
 *SEE TYP. SHEATHING FASTENER SCHEDULE DIAGRAM ON PAGE 6.

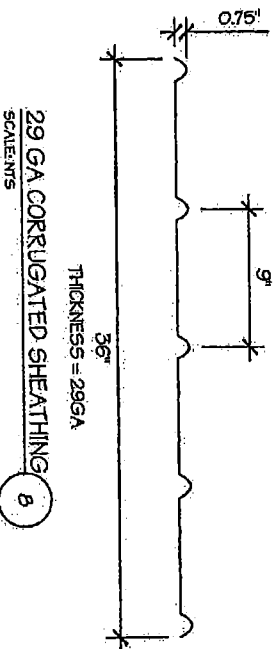

29 GA CORRUGATED SHEATHING 6
 SCALE: NTS

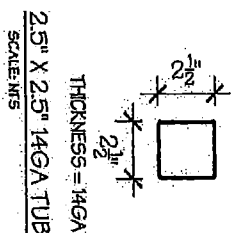

THICKNESS = 14GA
 2.5" X 2.5" 14GA TUBE 1
 SCALE: NTS

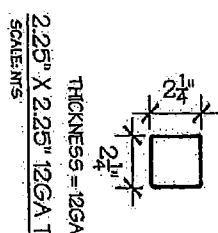

THICKNESS = 12GA
 2.25" X 2.25" 12GA TUBE 2
 SCALE: NTS

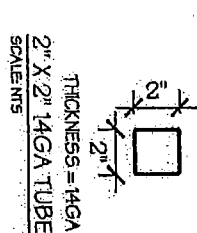

THICKNESS = 14GA
 2" X 2" 14GA TUBE 3
 SCALE: NTS

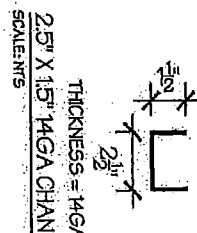

THICKNESS = 14GA
 2.5" X 1.5" 14GA CHANNEL 4
 SCALE: NTS

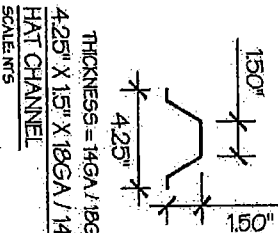

THICKNESS = 14GA / 18GA
 4.25" X 1.5" X 18GA / 14GA HAT CHANNEL 5
 SCALE: NTS

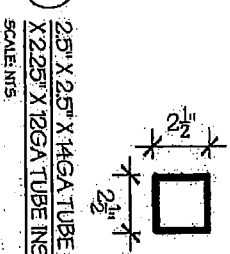

THICKNESS = 14GA TUBE W/ 2.25" X 2.25" X 12GA TUBE INSERT 11
 SCALE: NTS

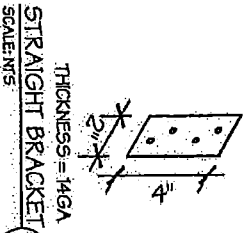

THICKNESS = 14GA
 STRAIGHT BRACKET 6
 SCALE: NTS

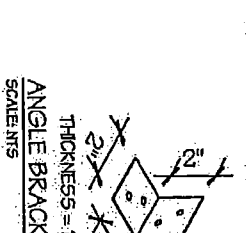

THICKNESS = 14GA
 ANGLE BRACKET 7
 SCALE: NTS

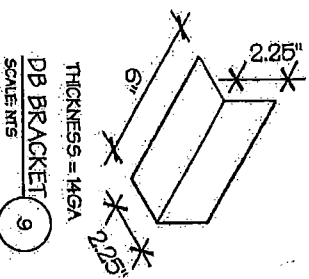

THICKNESS = 14GA
 DB BRACKET 9
 SCALE: NTS

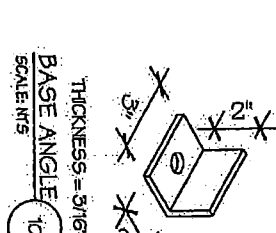

THICKNESS = 3/16"
 BASE ANGLE 10
 SCALE: NTS

MANUFACTURED BY:



457 N. Broadway,
 Joshua, TX 76058
 1-866-730-9865

ENGINEERED BY:



A&A ENGINEERING
 CIVIL - STRUCTURAL
 6035 Renaissance Fwy., Toledo, OH 43023
 Tel: 419-292-1085 • Fax: 419-292-0535
 www.a-a-engineers.com

DRAWING INFORMATION

PROJECT: 26'-0" WIDE BUILDINGS
 LOCATION: STATE OF OHIO
 PROJECT NO.: 035-23-0120
 SHEET TITLE:
 SCHEDULES & MEMBER SECTIONS

SHEET NO.: 2 / 11
 DRAWN BY: AW DATE: 1/24/22
 CHECKED BY: OAA DATE: 1/24/22

LEGAL INFORMATION

* ANY DUPLICATION OF THIS DRAWING IN WHOLE OR PART IS STRICTLY PROHIBITED. ANYONE DOING SO WILL BE PROSECUTED UNDER THE FULL FORCE OF THE LAW.
 -DRAWINGS VALID UP TO DATE OF EXPIRATION.

SEAL:

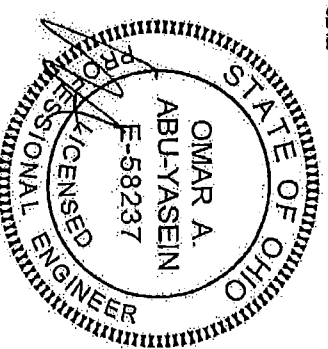

STAMP EXPIRY: 12-31-2023
 DATE SIGNED: 01-26-2023

MANUFACTURED BY:

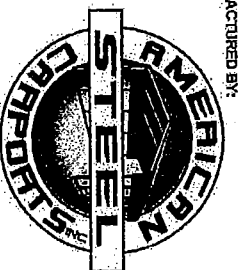

457 N. Broadway,
Joshua, TX 76058
1-866-730-9865

ENGINEERED BY:



A&A ENGINEERING
CIVIL - STRUCTURAL
6035 Remembrance Place, Toledo, OH 43623
Tel: 419-292-1983 • Fax: 419-292-0255
www.aandengineering.com

DRAWING INFORMATION

PROJECT: 26'-0" WIDE BUILDINGS
LOCATION: STATE OF OHIO
PROJECT NO.: 033-23-0120
SHEET TITLE: FRAME SECTIONS & DETAILS

SHEET NO.: 3 / 11
DRAWN BY: AW DATE: 1/24/22
CHECKED BY: OAA DATE: 1/24/22

LEGAL INFORMATION

- ANY DUPLICATION OF THIS DRAWING IN WHOLE OR PART IS STRICTLY PROHIBITED. ANYONE DOING SO WILL BE PROSECUTED UNDER THE FULL EXTENT OF THE LAW.
- DRAWINGS VALID UP TO DATE OF CANCELLATION.

SEAL:

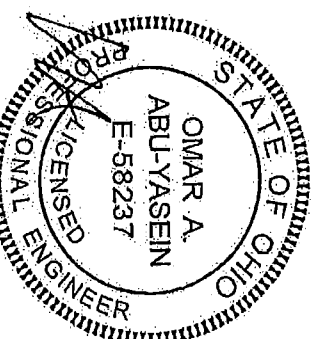

STAMP EXPIRY: 12-31-2023
DATE SIGNED: 01-26-2023

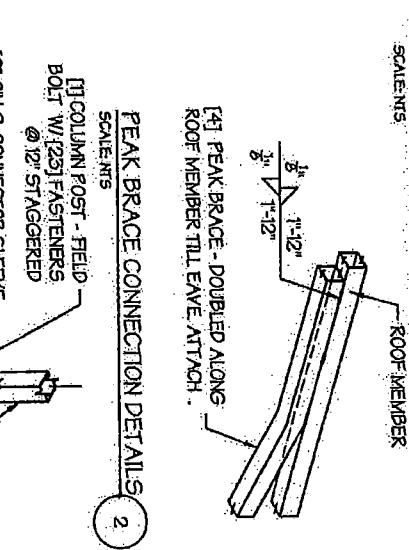
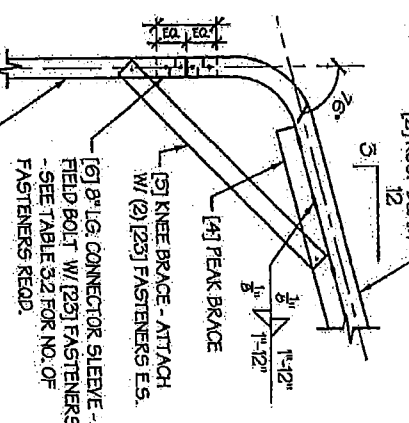
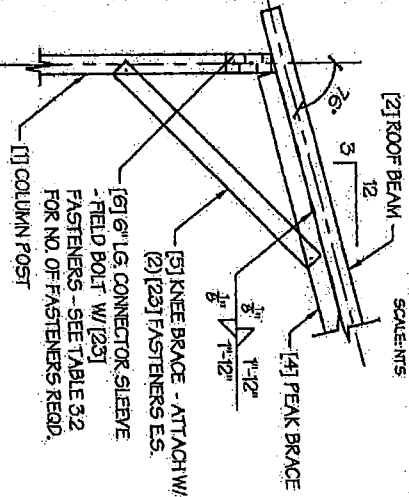
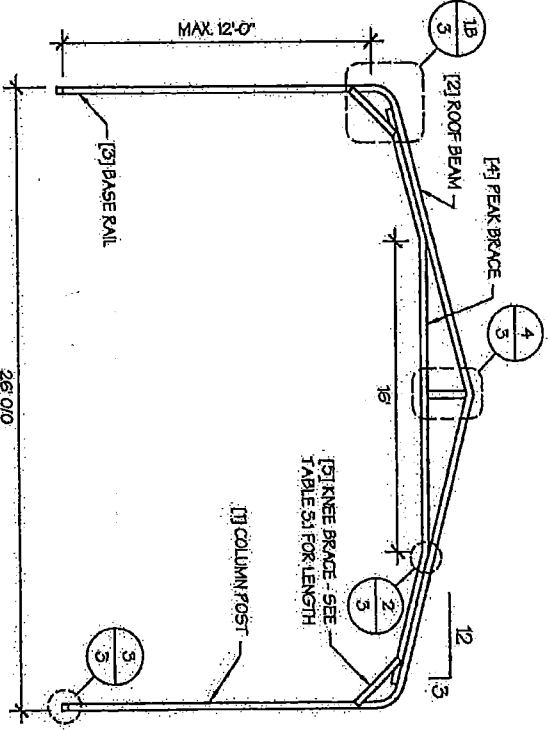
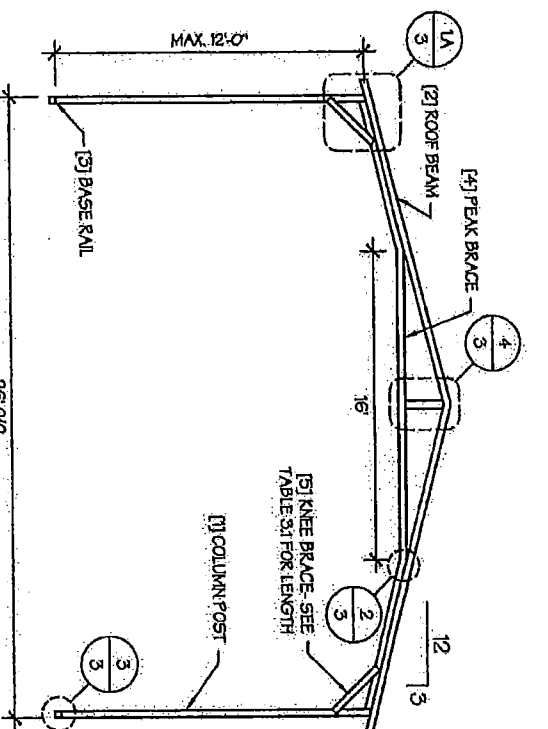

TABLE 3.1: KNEE BRACE SCHEDULE

EAVE HEIGHT	KNEE BRACE LENGTH
□ UP TO 8'	24"
□ 9' TO 12'	36"

TABLE 3.2 FASTENER SCHEDULE

WIND SPEED (MPH)	NO. OF FASTENERS
□ 105 TO 125	4
□ 130 TO 155	6
□ 160 TO 180	8

FB SUPPORT DETAIL

NOTE: COLUMN POST MAY BE ADJUSTED 4" FOR LEVELING. MANUFACTURER IS NOT RESPONSIBLE FOR LEVELING OF GROUND AND/OR CONCRETE SURFACE PROVIDED BY OTHERS.

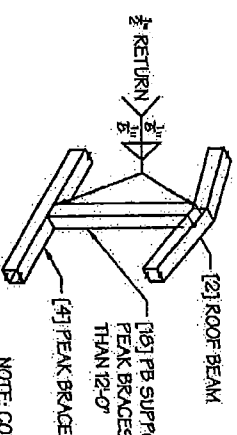

BASE DETAIL



TABLE 4: FRAME SPACING CHART / SCHEDULE

EAVE HEIGHT = UP TO 6'-0"		EAVE HEIGHT = 7'-0" TO 9'-0"		EAVE HEIGHT = 10'-0" TO 12'-0"																	
GROUND SNOW / ROOF LIVE LOAD (PSF)		ENCLOSED BUILDINGS										OPEN BUILDINGS									
		WIND SPEED (MPH)										WIND SPEED (MPH)									
		105	115	130	140	155	165	180	105	115	130	140	155	165	180						
30/20	60	60	54/60	54	48	42/48	36/42	54/60	48/54	42/54	42/48	36/42	36/42	30/36	30/36						
40/27	48/60	48/60	42/60	42/54	42/48	42/48	36/42	48/60	48/54	42/54	42/48	36/42	36/42	30/36	30/36						
50/34	40/54	40/54	40/54	40/54	40/48	40/48	36/42	40/54	40/48	40/48	40/48	36/42	36/42	30/36	30/36						
60/41	36/48	36/48	36/48	36/48	36/48	36/48	36/42	36/48	36/48	36/48	36/48	36/42	36	36	30						
70/47	32/42	32/42	32/42	32/42	32/42	32/36	32/36	32/42	32/36	32/36	32/36	32/36	30	30	30						
80/54	30/42	30/42	30/42	30/42	30/36	30/36	30/36	24	24	24	24	24	24	24	24						
90/61	24	24	24	24	24	24	24	18	18	18	18	18	18	18	18						
30/20	60	60	54/60	54	48	42/48	36/42	54/60	48/60	42/60	42/54	36/48	36/48	36/42	30/36						
40/27	48/60	48/60	42/60	42/54	42/48	42/48	36/42	48/60	48/54	42/54	42/54	36/48	36/48	36/42	30/36						
50/34	40/54	40/54	40/54	40/54	40/48	40/48	36/42	40/54	40/48	40/48	40/48	36/48	36/48	36/42	30/36						
60/41	36/48	36/48	36/48	36/48	36/48	36/48	36/42	36/48	36/48	36/48	36/48	36/42	36/42	36/42	30/36						
70/47	32/42	32/42	32/42	32/42	32/42	32/42	32/42	32/36	32/36	32/36	32/36	32/36	32/36	32/36	30/36						
80/54	30/42	30/42	30/42	30/42	30/42	30/36	30/36	30/36	30/36	30/36	30/36	30/36	30/36	30/36	30						
90/61	30/36	30/36	30/36	30/36	30/36	30/36	30/36	24	24	24	24	24	24	24	24						

NOTES:

1. FRAME SPACINGS ARE IN UNITS OF INCHES (IN).
2. WHERE TWO VALUES ARE SHOWN, THE HIGHER VALUE CAN ONLY BE USED FOR VERTICAL SHEATHING.
3. SNOW LOADS AND ROOF LIVE LOADS ARE IN POUNDS PER SQUARE FOOT (PSF). WIND SPEED IS 3 SEC. GUST IN MILES PER HOUR (MPH).
4. FOR VALUES THAT LIE BETWEEN TWO CELLS, THE HIGHER (MORE STRINGENT) VALUE HAS TO BE USED. INTERPOLATION BETWEEN CELLS IS NOT ALLOWED.

ENCLOSURE CLASSIFICATION:

1. ENCLOSED BUILDING = ALL 4 WALLS FULLY ENCLOSED WITH DOORS/WINDOWS = USE ENCLOSED BUILDING SPACING CHART.
2. OPEN BUILDING = ALL 4 WALLS FULLY OPEN = USE OPEN BUILDING SPACING CHART.
3. 3/4 PARTIALLY ENCLOSED = BOTH END-WALLS FULLY OPEN, WITH BOTH SIDE-WALLS ONLY 3/4 ENCLOSED = USE OPEN BUILDING SPACING CHART.
4. PARTIALLY ENCLOSED = BOTH END-WALLS FULLY OPEN, WITH BOTH SIDE-WALLS ENCLOSED MORE THAN 3/4 = START WITH OPEN BUILDING SPACING CHART AND THEN REDUCE SPACING BY 6".
5. 5 SIDED ENCLOSED = ALL WALLS ARE ENCLOSED EXCEPT FOR 1 END-WALL = START WITH ENCLOSED BUILDING SPACING + THE OPEN END FRAME MUST HAVE EITHER A GABLED END OR HAVE DOUBLED WELDED LEGS & ROOF.
6. FOR ALL SHEATHING ENCLOSURES NOT LISTED ABOVE, REFER TO SHEET 5 FOR SPACING AND DESIGN REQUIREMENTS.

GENERAL NOTES:

1. THE MAX BUILDING LENGTH FOR ENCLOSED BUILDINGS IS 50'-0". THIS CAN BE INCREASED BY ADDING A DOUBLE FRAME AT THE CENTER TO BREAK THE LENGTH OF THE BUILDING.
2. BUILDINGS WITH PARTIALLY ENCLOSED END WALLS NEED TO HAVE SIDE WALL BRACING TO SUPPORT THE PARTIALLY ENCLOSED END WALL. (SEE FIGURE A ON SHEET 5).

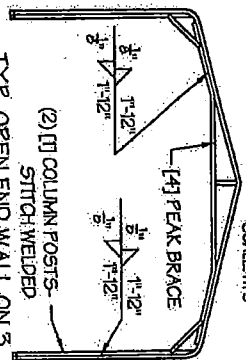
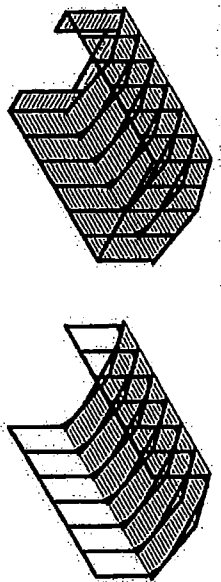

457 N. Broadway,
Joshua, TX 76058
1-866-730-9865



CIVIL-STRUCTURAL
6035 Renaissance Blvd., Toledo, OH 43623
Tel. 419-529-1083 • Fax 419-292-0855
www.aandengineering.com

DRAWING INFORMATION
PROJECT: 26'-0" WIDE BUILDINGS
LOCATION: STATE OF OHIO
PROJECT NO.: 035-23-0120
SHEET TITLE:
SPACING SCHEDULES
& ENCLOSURE NOTES

SHEET NO.: 4 / 11
DRAWN BY: AW DATE: 1/24/22
CHECKED BY: OAA DATE: 1/24/22

LEGAL INFORMATION:

ANY REPRODUCTION OF THIS DRAWING IN WHOLE OR IN PART IS STRICTLY PROHIBITED. ANYONE DOING SO WILL BE PROSECUTED UNDER THE FULL EXTENT OF THE LAW.
DRAWINGS VALID UP TO DATE OF EXPIRATION.

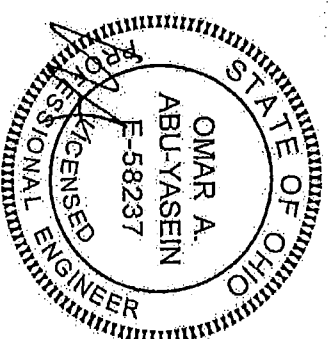

STAMP EXPIRY: 12-31-2023
DATE SIGNED: 01-26-2023

TABLE 5.1: PURLIN SPACING SCHEDULE

GROUND SNOW / ROOF LIVE LOAD (PSF)	WIND SPEED (MPH)									
	105	115	130	140	150	165	180	200	220	240
30/20	54	48	42	36	30	24	24	24	24	24
40/27	42	42	42	36	30	24	24	24	24	24
50/34	40	40	40	36	30	24	24	24	24	24
60/41	36	36	36	36	30	24	24	24	24	24
70/47	32	32	32	32	30	24	24	24	24	24
80/54	30	30	30	30	30	24	24	24	24	24
90/61	24	24	24	24	24	24	24	24	24	24
30/20	54	48	42	42	36	30	30	30	30	30
40/27	42	42	42	42	36	30	30	30	30	30
50/34	40	40	40	40	36	30	30	30	30	30
60/41	36	36	36	36	36	30	30	30	30	30
70/47	32	32	32	32	32	30	30	30	30	30
80/54	30	30	30	30	30	30	30	30	30	30
90/61	30	30	30	30	30	30	30	30	30	30
30/20	54	48	42	42	36	36	36	36	36	36
40/27	42	42	42	42	36	36	36	36	36	36
50/34	40	40	40	40	36	36	36	36	36	36
60/41	36	36	36	36	36	36	36	36	36	36
70/47	32	32	32	32	32	32	32	32	32	32
80/54	30	30	30	30	32	32	32	32	32	32
90/61	30	30	30	30	30	30	30	30	30	30
30/20	54	48	42	42	36	36	36	36	36	36
40/27	42	42	42	42	36	36	36	36	36	36
50/34	40	40	40	40	36	36	36	36	36	36
60/41	36	36	36	36	36	36	36	36	36	36
70/47	32	32	32	32	32	32	32	32	32	32
80/54	30	30	30	30	32	32	32	32	32	32
90/61	30	30	30	30	30	30	30	30	30	30
30/20	54	48	42	42	36	36	36	36	36	36
40/27	42	42	42	42	36	36	36	36	36	36
50/34	40	40	40	40	36	36	36	36	36	36
60/41	36	36	36	36	36	36	36	36	36	36
70/47	32	32	32	32	32	32	32	32	32	32
80/54	30	30	30	30	32	32	32	32	32	32
90/61	30	30	30	30	30	30	30	30	30	30
30/20	54	48	42	42	36	36	36	36	36	36
40/27	42	42	42	42	36	36	36	36	36	36
50/34	40	40	40	40	36	36	36	36	36	36
60/41	36	36	36	36	36	36	36	36	36	36
70/47	32	32	32	32	32	32	32	32	32	32
80/54	30	30	30	30	32	32	32	32	32	32
90/61	30	30	30	30	30	30	30	30	30	30
30/20	54	48	42	42	36	36	36	36	36	36
40/27	42	42	42	42	36	36	36	36	36	36
50/34	40	40	40	40	36	36	36	36	36	36
60/41	36	36	36	36	36	36	36	36	36	36
70/47	32	32	32	32	32	32	32	32	32	32
80/54	30	30	30	30	32	32	32	32	32	32
90/61	30	30	30	30	30	30	30	30	30	30

NOTES:

1. PURLIN SPACING UNITS ARE IN INCHES.
2. FRAME SPACING NEEDS TO BE DETERMINED FROM TABLE 4.

IRREGULAR BUILDING NOTES:

1. FIGURES A, B, C & D ON THE RIGHT INDICATE EXAMPLES OF IRREGULAR BUILDINGS.
2. FOR IRREGULAR BUILDINGS, FRAME SPACING MUST BE REDUCED BY 6" FROM OPEN BUILDING SPACING TABLE. SEE SHEET 4 FOR OPEN BUILDING TABLE.
3. SITE SPECIFICS MAY ALLOW FOR ALTERNATIVE SPACING.

TABLE 5.2: GIRT SPACING SCHEDULE

FRAME SPACING	WIND SPEED (MPH)									
	105	115	130	140	150	165	180	200	220	240
05-0'	60	48	36	30	24	24	18	18	18	18
04-6"	60	60	48	42	36	30	24	24	24	24
04-0'	60	60	54	54	42	36	30	30	30	30
03-6"	60	60	54	54	48	42	42	42	42	42
02-0 TO 03-0'	60	60	54	54	48	42	42	42	42	42

NOTES:

1. GIRT SPACING UNITS ARE IN INCHES.
2. THIS SCHEDULE IS TO BE USED FOR BOTH 14GA
3. FRAME SPACING NEEDS TO BE DETERMINED FROM TABLE 4.

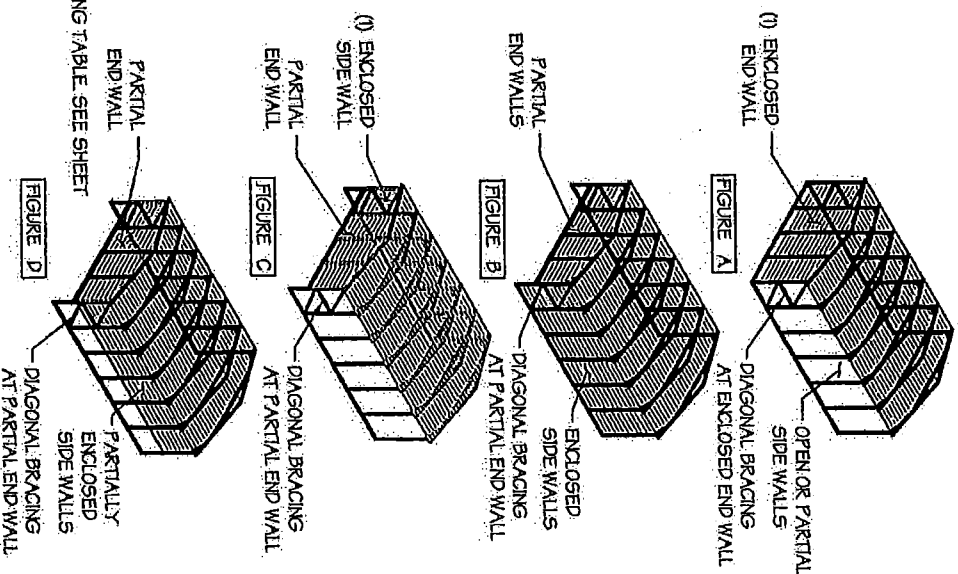

MANUFACTURED BY:

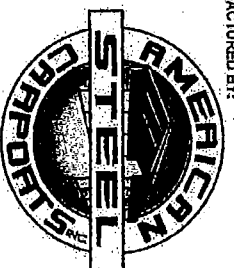

457 N. Broadway,
Joshua, TX 76058
1-866-730-9865

ENGINEERED BY:



A&A ENGINEERING
CIVIL - STRUCTURAL
6007 Tomlinson Drive, Toledo, OH 43623
Tel: 419-292-1185 • Fax: 419-292-0585
www.a-a-engineering.com

DRAWING INFORMATION

PROJECT: 26'-0" WIDE BUILDINGS

LOCATION: STATE OF OHIO

PROJECT NO.: 035-23-0120

SHEET TITLE:

PURLIN & GIRT
SPACING SCHEDULES

SHEET NO.: 5 / 11

DRAWN BY: AW DATE: 1/24/22

CHECKED BY: OAA DATE: 1/24/22

LEGAL INFORMATION:

- ANY DUPLICATION OF THIS DRAWING IN WHOLE OR
PART IS STRICTLY PROHIBITED. THE FULL EXACT COPY MUST
BE PROVIDED TO THE CLIENT. ANY OTHER COPIES
- DRAWINGS VOID UP TO DATE OF EXPIRATION.

SEAL:

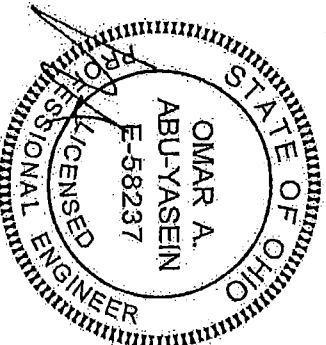

STAMP EXPIRY: 12-31-2023

DATE SIGNED: 01-26-2023

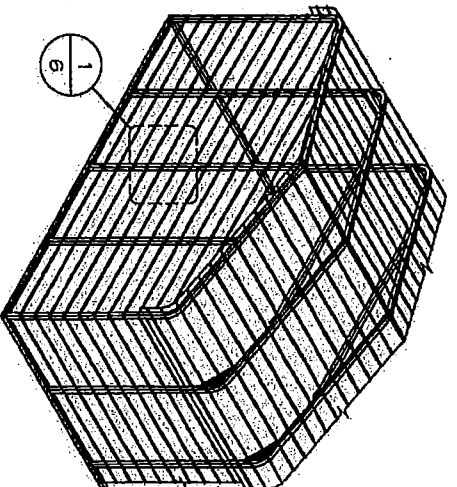

☐ TYP. HORIZONTAL SHEATHING
SCALE: NTS

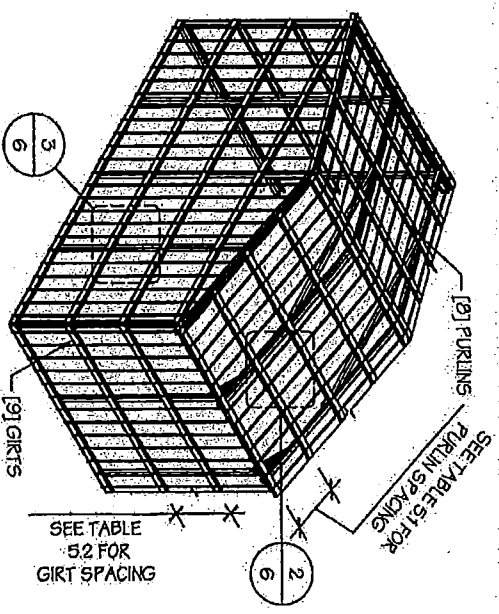

☐ TYP. VERTICAL SHEATHING
SCALE: NTS

- GENERAL SHEATHING NOTES:**
1. REGULAR STYLE BUILDINGS CAN ONLY HAVE HORIZONTAL SHEATHING ON ROOF AND WALLS. A-FRAME STYLE BUILDINGS CAN HAVE ANY COMBINATION OF HORIZONTAL OR VERTICAL SHEATHING ON ROOFS AND WALLS. BOTH HORIZONTAL AND VERTICALS ROOF SHEATHING CAN HAVE MAX 6" OVERHANG.
 2. USING VERTICAL SHEATHING MAY ALLOW FOR GREATER FRAME SPACING. SEE NOTE 2 UNDER TABLE 4.
 3. VERTICAL SHEATHING RECOMMENDED FOR BUILDINGS 30' OR LONGER.

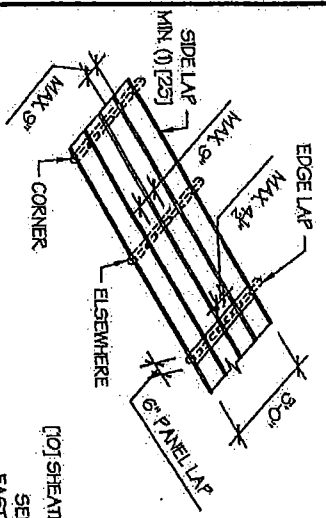

[10] SHEATHING
SEE TABLE 2.2 FOR FASTENER SCHEDULE

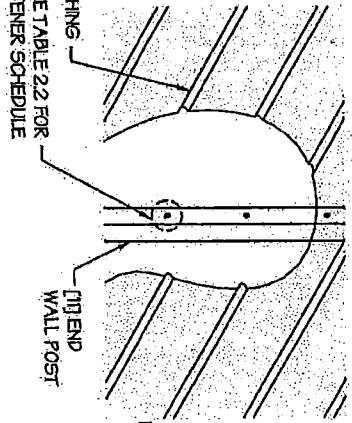

SEE TABLE 2.2 FOR FASTENER SCHEDULE
[10] SHEATHING
ATTACH PURLINS TO ROOF BEAMS W/ (2) [23] FASTENERS

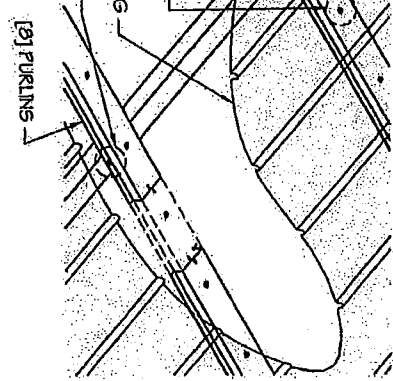

TYP. SHEATHING FASTENER SCHEDULE
SCALE: NTS

TYP. HORIZONTAL SHEATHING DETAIL 1
SCALE: NTS

ROOF VERTICAL SHEATHING DETAIL 2
SCALE: NTS

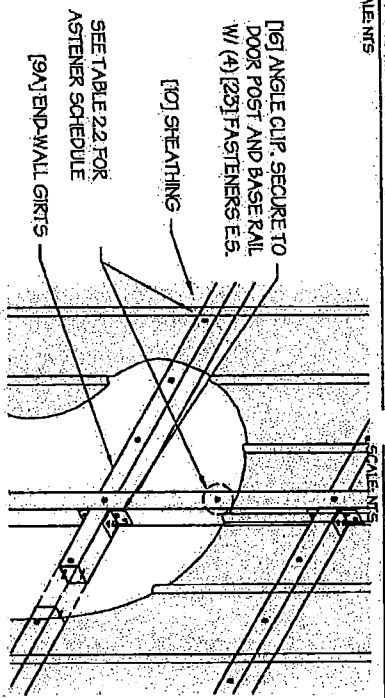

SEE TABLE 2.2 FOR FASTENER SCHEDULE

☐ WALL VERTICAL SHEATHING - TUBE DETAIL 3
SCALE: NTS

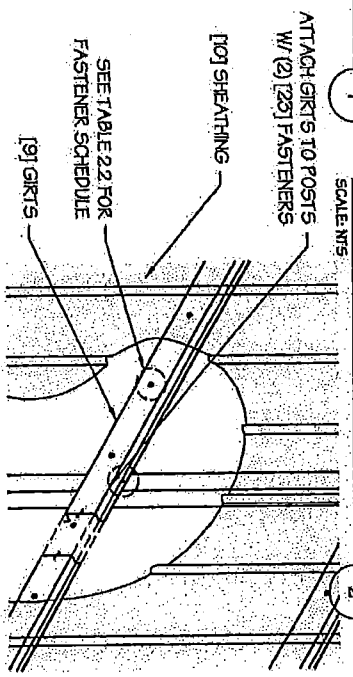

☐ WALL VERTICAL SHEATHING - HAT CHANNEL DETAIL 5
SCALE: NTS

MANUFACTURED BY:



467 N. Broadway,
Joshua, TX 76058
1-866-730-9865

ENGINEERED BY:



A&A ENGINEERING
CIVIL - STRUCTURAL
6357 Bendure Road, Toledo, OH 43623
Tel. 419-292-1085 • Fax 419-292-0555
www.aandengr.com

DRAWING INFORMATION

PROJECT: 26'-0" WIDE BUILDINGS
LOCATION: STATE OF OHIO
PROJECT NO.: 035-23-0120
SHEET TITLE:
SHEATHING OPTIONS
& DETAILS

SHEET NO.: 6 / 11
DRAWN BY: NW DATE: 1/24/22
CHECKED BY: OAA DATE: 1/24/22

LEGAL INFORMATION

- ANY DUPLICATION OF THIS DRAWING IN WHOLE OR PART IS STRICTLY PROHIBITED. ANYONE DOING SO WILL BE PROSECUTED UNDER THE DATE OF EXPIRATION.
- DRAWINGS VALID UP TO DATE OF EXPIRATION.

SEAL:

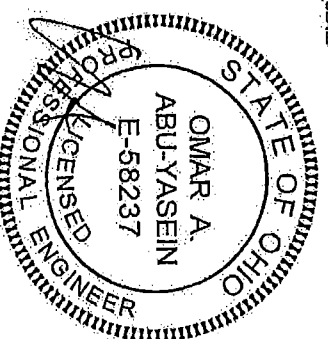

STAMP EXPIRY: 12-31-2023
DATE SIGNED: 01-26-2023

MANUFACTURED BY:

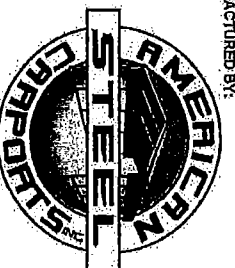

457 N. Broadway,
Joshua, TX 76058
1-866-730-9865

ENGINEERED BY:



A&A ENGINEERING
CIVIL - STRUCTURAL
6035 Mentorship Place, Toledo, OH 43623
Tel: 419-592-1983 • Fax: 419-592-0955
www.aandae.com

DRAWING INFORMATION

PROJECT: 26'-0" WIDE BUILDINGS

LOCATION: STATE OF OHIO

PROJECT NO.: 033-23-0120

SHEET TITLE:

SIDE WALL FRAMING
& OPENINGS

SHEET NO.: 7-A / 11

DRAWN BY: AW DATE: 1/24/22

CHECKED BY: OAA DATE: 1/24/22

LEGAL INFORMATION

- ANY DUPLICATION OF THIS DRAWING IN WHOLE OR
PART IS STRICTLY FORBIDDEN. ANYONE DOING SO WILL
BE PROSECUTED UNDER THE FULL EXTENT OF THE LAW.
- DRAWINGS VALID UP TO DATE OF EXPIRATION.

SEAL:

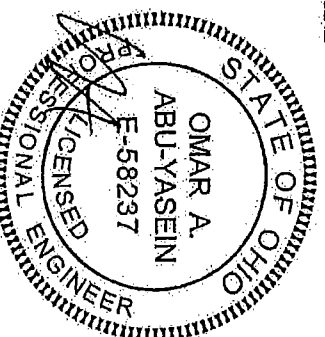

☐ SIDE WALL OVERHEAD DOOR OPENINGS WITH TRUSS STYLE HEADER

SCALE: NTS

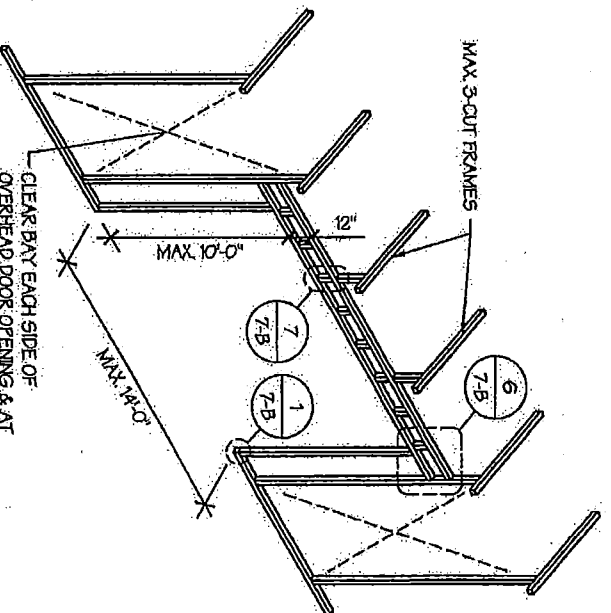

☐ SIDE WALL OVERHEAD DOOR OPENINGS

SCALE: NTS

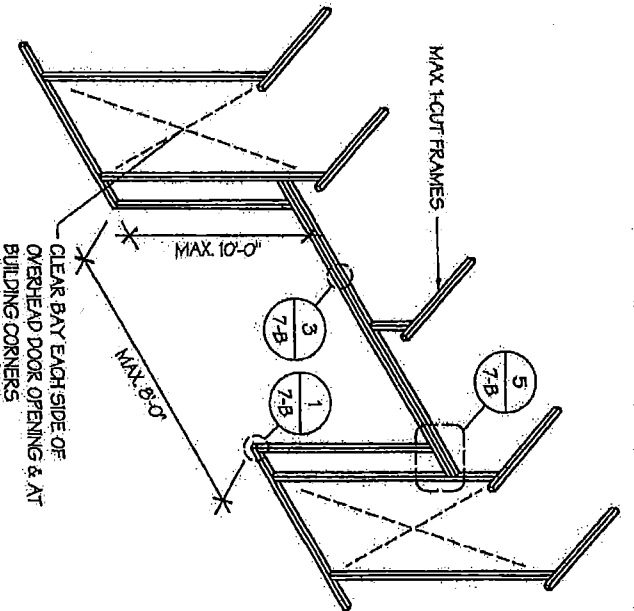

SIDE WALL FRAMING NOTES:

1. TRUSS-STYLE HEADERS ARE REQUIRED FOR WHERE THE GROUND SNOW LOAD IS 40 PSF OR GREATER.
2. DESIGNS AND DETAILS SHOWN HERE ARE APPLICABLE TO BOTH REGULAR AND A-FRAME STYLE BUILDINGS.
3. MAX. HEIGHT OF SIDE WALL OVERHEAD DOOR OPENINGS IS 2 FT LESS THAN THE EAVE HEIGHT.
4. OVERHEAD DOOR OPENINGS CANNOT CUT THROUGH MORE THAN 2 FULL FRAMES.
5. MIN. 1 CLEAR BAY MUST BE MAINTAINED BETWEEN ANY 2 OVERHEAD DOOR OPENINGS. A CLEAR BAY IS A SPACE BETWEEN TWO FRAMES THAT HAS NO OVERHEAD DOOR OPENINGS.
6. MIN. 1 CLEAR BAY MUST ALSO BE MAINTAINED FROM THE BUILDING CORNERS.
7. SERVICE DOORS AND WINDOWS CAN BE PLACED IN CLEAR BAYS OR ANY WHERE ELSE AS NEEDED.

☐ SIDE WALL SERVICE DOOR / WINDOW OPENINGS

SCALE: NTS

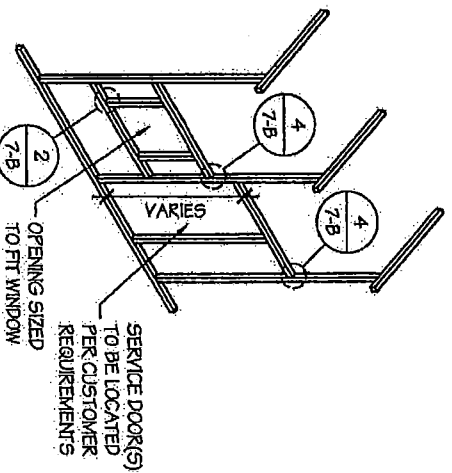

MANUFACTURED BY:

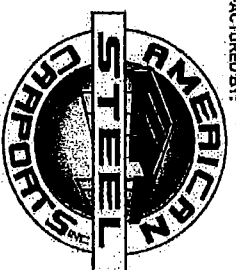

457 N. Broadway,
Joshua, TX 76058
1-866-730-9865

ENGINEERED BY:



A&A ENGINEERING
CIVIL-STRUCTURAL
40867 Sanderson Blvd., Toledo, OH 43623
Tel: 419-292-1083 • Fax: 419-292-0655
www.a-a-engineering.com

DRAWING INFORMATION

PROJECT: 26'-0" WIDE BUILDINGS

LOCATION: STATE OF OHIO

PROJECT NO.: 033-23-0120

SHEET TITLE:

SIDE WALL FRAMING DETAILS

SHEET NO.: 7-B / 11

DRAWN BY: AW DATE: 1/24/22

CHECKED BY: OAA DATE: 1/24/22

LEGAL INFORMATION

ANY REPRODUCTION OF THIS DRAWING IN WHOLE OR IN PART WITHOUT THE WRITTEN PERMISSION OF THE ENGINEER SHALL BE PROSECUTED UNDER THE FULL EXTENT OF THE LAW.
DRAWINGS VALID UP TO DATE OF EXPIRATION.

SEAL:

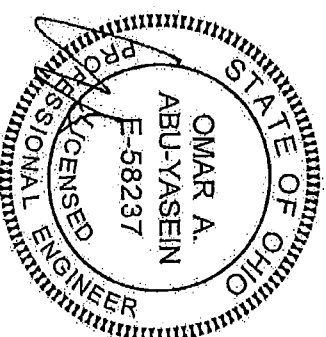

STAMP EXPIRY: 12-31-2023

DATE SIGNED: 01-26-2023

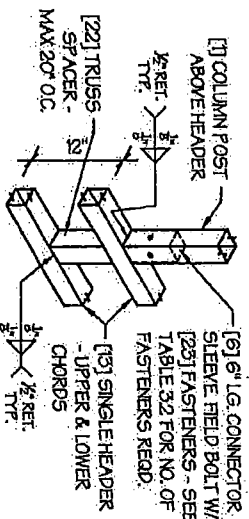
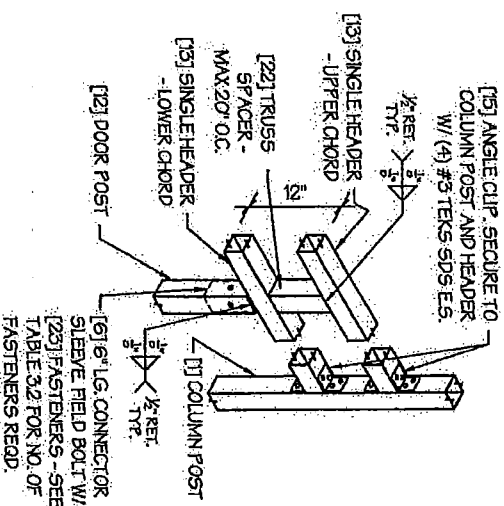
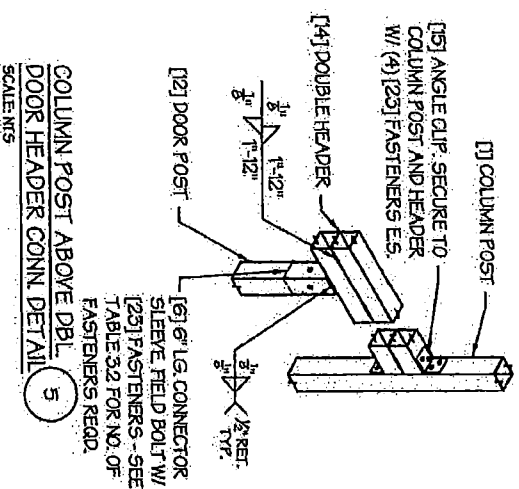
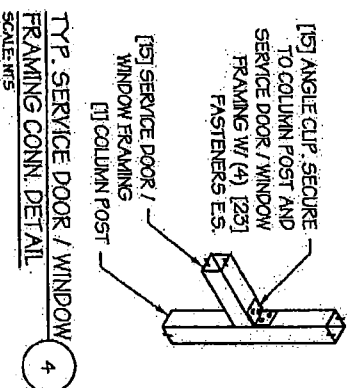
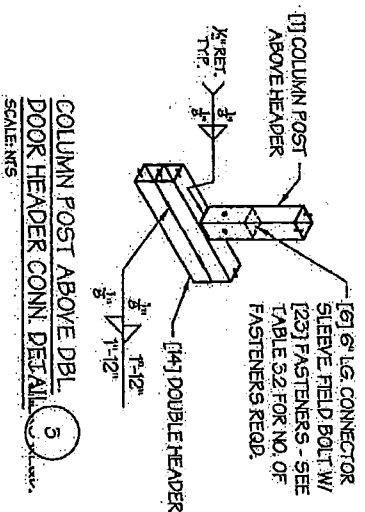
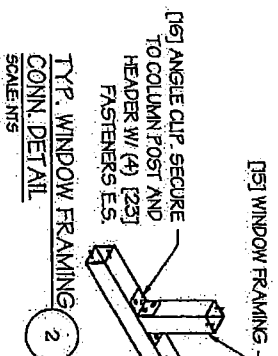
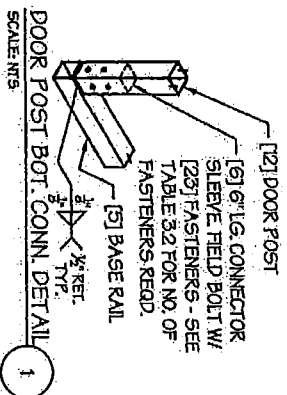

MANUFACTURED BY:

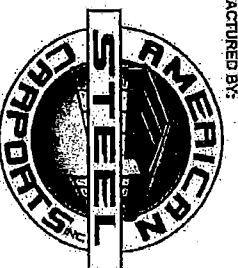

457 N. Broadway,
Joshua, TX 76058
1-866-730-9865

ENGINEERED BY:



A&A ENGINEERING
CIVIL - STRUCTURAL
5026 Remondine Pkwy., Toledo, OH 43623
Tel. 419-292-1983 • Fax. 419-292-0955
www.a-a-engineers.com

DRAWING INFORMATION

PROJECT: 26'-0" WIDE BUILDINGS

LOCATION: STATE OF OHIO

PROJECT NO.: 033-23-0120

SHEET TITLE:

END WALL FRAMING

SHEET NO.: B-A / 11

DRAWN BY: AW DATE 1/24/22

CHECKED BY: OAA DATE 1/24/22

LEGAL INFORMATION

- ANY DUPLICATION OF THIS DRAWING IN WHOLE OR PART IS STRICTLY PROHIBITED. ANYONE DOING SO WILL BE PROSECUTED UNDER THE FULL EXTENT OF THE LAW.
- DRAWINGS VALID UP TO DATE OF EXPIRATION.

SEAL:

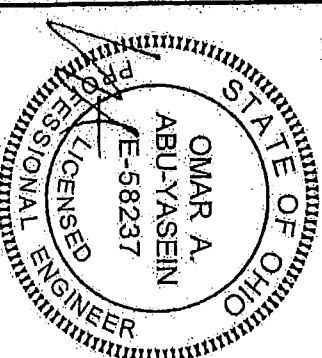

STAMP EXPIRY: 12-31-2023

DATE SIGNED: 01-26-2023

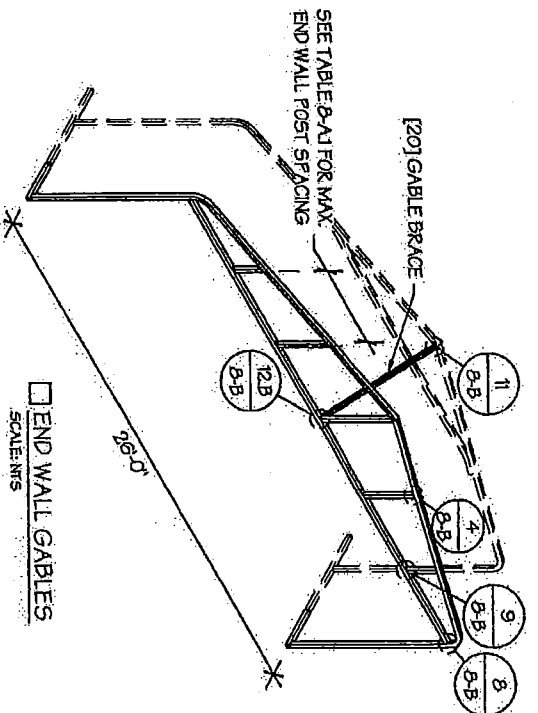

END WALL OVERHEAD DOOR OPENINGS

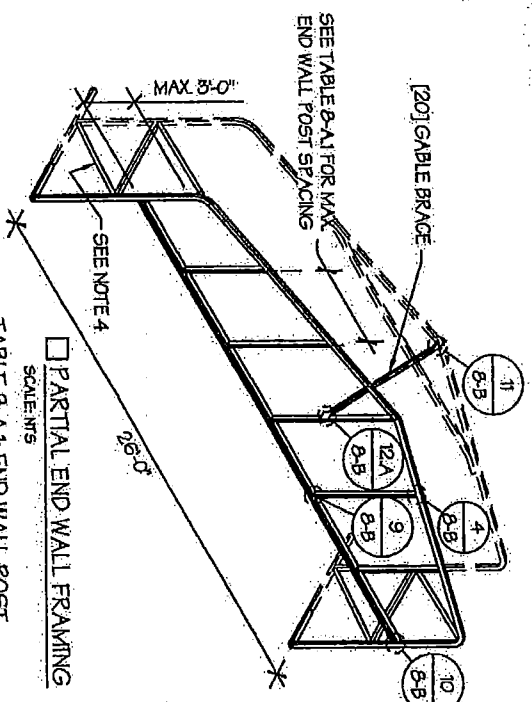
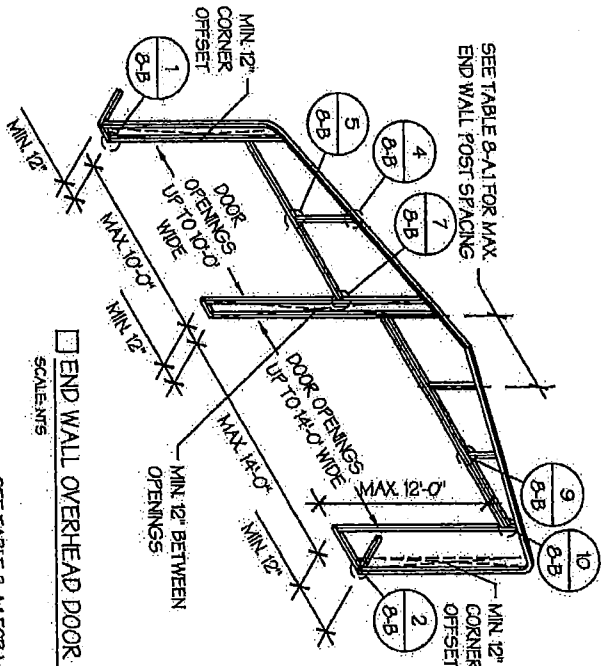

PARTIAL END WALL FRAMING

TABLE B-A.1: END WALL POST SPACING SCHEDULE

WIND SPEED (MPH)	UP TO 7'	8' TO 9'	10' TO 12'
105	5'	5'	5'
115	5'	5'	4.5'
130	4.5'	4.5'	4'
140	4.5'	4.5'	3'
155	4'	4'	2.5'
165 - 180	3.5'	3'	2'

GABLE BRACING NOTE

1. GABLE BRACE IS ONLY REQUIRED FOR PARTIALLY ENCLOSED END WALLS (END WALL POSTS ARE NOT ANCHORED TO THE GROUND).
2. FULLY ENCLOSED OR OPEN END WALLS DO NOT REQUIRE GABLE BRACING.

END WALL FRAMING NOTES:

1. DESIGNS AND DETAILS SHOWN HERE ARE APPLICABLE TO BOTH REGULAR AND A-FRAME STYLE BUILDINGS.
2. MIN. 12" CLEARANCE MUST BE MAINTAINED BETWEEN ANY TWO OPENINGS (OVERHEAD DOOR OR SERVICE DOOR) AND FROM CORNERS.
3. SERVICE DOORS AND WINDOWS CAN BE PLACED AS NEEDED.
4. DIAGONAL BRACES NEED TO BE ADDED FOR PARTIAL END WALL ENCLOSURES. SEE SHEET 9 FOR DIAGONAL BRACE CONNECTION DETAILS.

MANUFACTURED BY:



457 N. Broadway,
Joshua, TX 76058
1-866-730-9865

ENGINEERED BY:



A&A ENGINEERING
CIVIL - STRUCTURAL
6035 Northshore Place, Toledo, OH 43623
Tel. 419-292-1583 • Fax. 419-292-0955
www.aandae.com

DRAWING INFORMATION

PROJECT: 26'-0" WIDE BUILDINGS
LOCATION: STATE OF OHIO
PROJECT NO.: 033-23-0120
SHEET TITLE:
END WALL FRAMING
DETAILS

SHEET NO.: 8-B / 11

DRAWN BY: AW DATE: 1/24/22

CHECKED BY: OAA DATE: 1/24/22

LEGAL INFORMATION

- ANY DUPLICATION OF THIS DRAWING IN WHOLE OR PART IS STRICTLY FORBIDDEN. ANYONE DOING SO WILL BE PROSECUTED UNDER THE FULL EXTENT OF THE LAW.
- DRAWINGS VALID UP TO DATE OF EXPIRATION.

SEAL:

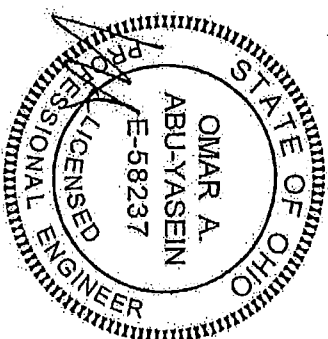

STAMP EXPIRY: 12-31-2023
DATE SIGNED: 01-26-2023

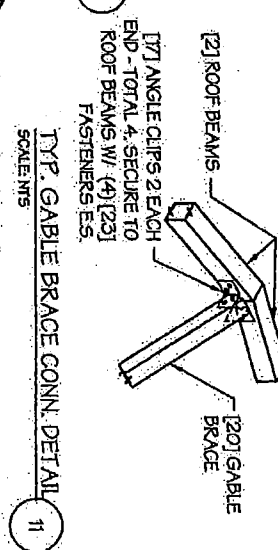
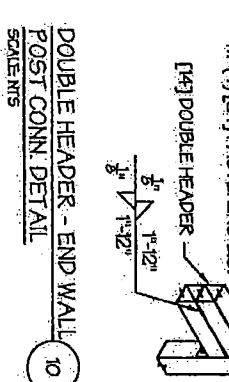
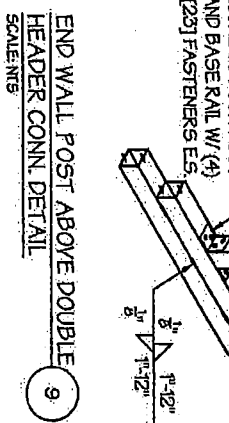
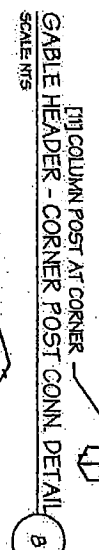
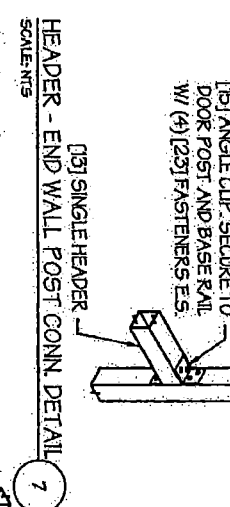
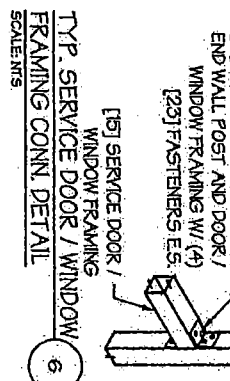
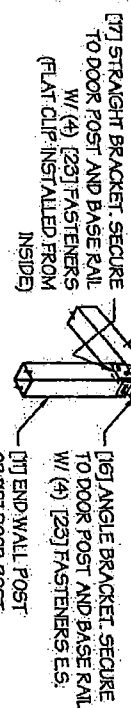
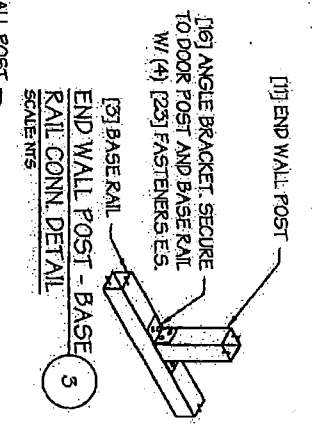
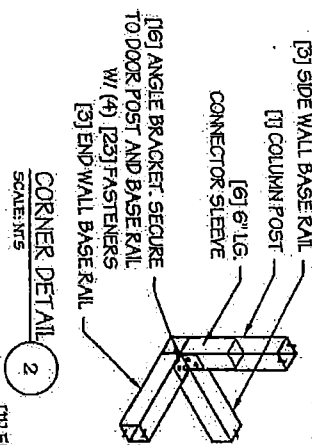
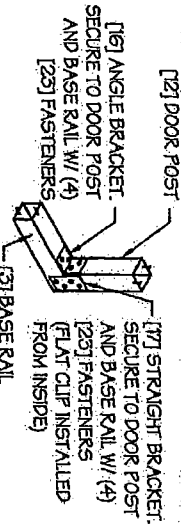

GABLE BRACING NOTE

1. GABLE BRACE IS ONLY REQUIRED FOR PARTIALLY ENCLOSED END WALLS (END WALL POSTS ARE NOT ANCHORED TO THE GROUND).
2. FULLY ENCLOSED OR OPEN END WALLS DO NOT REQUIRE GABLE BRACING.

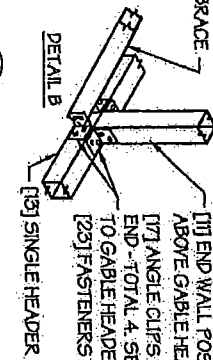
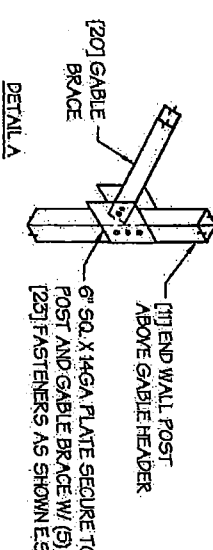

CONCRETE SLAB FOUNDATION NOTES:

- DESIGNS SHOWN ON THIS SHEET ARE FOR CONCRETE SLAB FOUNDATION. ANY OF THE FOUNDATIONS SHOWN ON SHEETS 11-A THRU D CAN BE USED.
- CONCRETE ANCHORS SHALL BE LOCATED NEXT TO EVERY POST AND ON EITHER SIDE OF OPENINGS. TWO ANCHORS SHALL BE INSTALLED AT CORNERS OF ENCLOSED BUILDINGS WITH END WALLS - ONE ON EACH BASE RAIL IN LOCATIONS REQUIRING TWO ANCHORS DUE TO WIND. ONE ANCHOR IS TO BE ON EACH SIDE OF THE COLUMN POST.
- ANCHORS IN CLOSE PROXIMITY TO EACH OTHER MUST HAVE A MIN. 4" SPACING.
- MIN. NUMBER OF CONCRETE ANCHORS PER POST SHALL BE AS SHOWN IN TABLE 11-A-2.
- THE SIZE OF THE SLAB SHALL BE THE SIZE (WIDTH AND LENGTH) OF THE BUILDING PLUS 5" FOR 14GA MATERIAL AND 5" FOR 12GA MATERIAL.
- DEPTH OF SLAB TURN DOWN FOOTING SHALL BE GREATER THAN FROST DEPTH SPECIFIED PER LOCAL CODE.
- CONTROL JOINTS SHALL BE PLACED 50 AS TO LIMIT MAX. SLAB SPANS TO 20' IN EACH DIRECTION.
- ASSUMED SOIL BEARING CAPACITY IS TO BE A MIN. OF 1500 PSF.
- CONCRETE STRENGTH TO BE A MIN. OF 2500 PSI @ 28 DAYS.

CONCRETE SLAB FOUNDATION

SCALE: NTS

TABLE 11-A-2: CONCRETE SLAB ANCHOR SCHEDULE

ENCLOSURE	WIND SPEED (MPH)	ANCHOR SIZE/NUMBER
ENCLOSED	105 TO 135	(1) 1/2" Ø X 7"
	136 TO 160	(2) 1/2" Ø X 7"
OPEN	105 TO 135	(1) 1/2" Ø X 7"
	136 TO 160	(2) 1/2" Ø X 7"

NOTES:

- ANCHORS ARE TO BE CONCRETE WEDGE OR EXPANSION ANCHORS.
- MIN. EMBEDMENT DEPTH TO BE 28".
- ANCHORS TO BE SPACED NO MORE THAN 6" FROM POSTS.

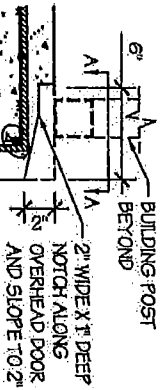

OVERHEAD DOOR NOTCH DETAIL

SCALE: NTS

TABLE 11-A-1: NOTCH WIDTH

HORIZONTAL / OPEN	VERTICAL
14GA	12GA
12GA	12GA
2 5/8"	2 7/8"
	1 3/4"
	1 7/8"

NOTE: DEPTH IS TO BE 1 1/2"

CONTROL JOINTS SPACED AT MAX 20'-0" O.C.

MAX 20'-0"

MIN 20'-0"

11-A

2

11-A

MAX 20'-0"

MIN 20'-0"

11-A

2

11-A

MAX 20'-0"

MIN 20'-0"

11-A

2

11-A

MAX 20'-0"

MIN 20'-0"

11-A

2

11-A

MAX 20'-0"

MIN 20'-0"

11-A

2

11-A

MAX 20'-0"

MIN 20'-0"

11-A

2

11-A

MAX 20'-0"

MIN 20'-0"

11-A

2

11-A

MAX 20'-0"

MIN 20'-0"

11-A

2

11-A

MAX 20'-0"

MIN 20'-0"

11-A

2

11-A

MAX 20'-0"

MIN 20'-0"

11-A

2

11-A

MAX 20'-0"

MIN 20'-0"

11-A

2

11-A

MAX 20'-0"

MIN 20'-0"

11-A

2

11-A

MAX 20'-0"

MIN 20'-0"

11-A

2

11-A

MAX 20'-0"

MIN 20'-0"

11-A

2

11-A

MAX 20'-0"

MIN 20'-0"

11-A

2

11-A

MAX 20'-0"

MIN 20'-0"

11-A

2

11-A

MAX 20'-0"

MIN 20'-0"

11-A

2

11-A

MAX 20'-0"

MIN 20'-0"

11-A

2

11-A

MAX 20'-0"

MIN 20'-0"

11-A

2

11-A

MAX 20'-0"

MIN 20'-0"

11-A

2

11-A

MAX 20'-0"

MIN 20'-0"

11-A

2

11-A

MAX 20'-0"

MIN 20'-0"

11-A

2

11-A

MAX 20'-0"

MIN 20'-0"

11-A

2

11-A

MAX 20'-0"

MIN 20'-0"

11-A

2

11-A

MAX 20'-0"

MIN 20'-0"

11-A

2

11-A

MAX 20'-0"

MIN 20'-0"

11-A

2

11-A

MAX 20'-0"

MIN 20'-0"

11-A

2

11-A

MAX 20'-0"

MIN 20'-0"

11-A

2

11-A

MAX 20'-0"

MIN 20'-0"

11-A

2

11-A

MAX 20'-0"

MIN 20'-0"

11-A

2

11-A

MAX 20'-0"

MIN 20'-0"

11-A

2

11-A

MAX 20'-0"

MIN 20'-0"

11-A

2

11-A

MAX 20'-0"

MIN 20'-0"

11-A

2

11-A

MAX 20'-0"

MIN 20'-0"

11-A

2

11-A

MAX 20'-0"

MIN 20'-0"

11-A

2

11-A

MAX 20'-0"

MIN 20'-0"

11-A

2

11-A

MAX 20'-0"

MIN 20'-0"

11-A

2

11-A

MAX 20'-0"

MIN 20'-0"

11-A

2

11-A

MAX 20'-0"

MIN 20'-0"

11-A

2

11-A

MAX 20'-0"

MIN 20'-0"

11-A

2

11-A

MAX 20'-0"

MIN 20'-0"

11-A

2

11-A

MAX 20'-0"

MIN 20'-0"

11-A

2

11-A

MAX 20'-0"

MIN 20'-0"

11-A

2

11-A

MAX 20'-0"

MIN 20'-0"

11-A

2

11-A

MAX 20'-0"

MIN 20'-0"

11-A

2

11-A

MAX 20'-0"

MIN 20'-0"

11-A

2

11-A

MAX 20'-0"

MIN 20'-0"

11-A

2

11-A

MAX 20'-0"

MIN 20'-0"

11-A

2

11-A

MAX 20'-0"

MIN 20'-0"

11-A

2

11-A

MAX 20'-0"

MIN 20'-0"

11-A

2

11-A

MAX 20'-0"

MIN 20'-0"

11-A

2

11-A

MAX 20'-0"

MIN 20'-0"

11-A

2

11-A

MAX 20'-0"

MIN 20'-0"

11-A

2

11-A

MAX 20'-0"

MIN 20'-0"

ORDINANCE NO. 002-2024

APPROVING AND MAKING A SUPPLEMENTAL APPROPRIATION IN THE AMOUNT OF EIGHT THOUSAND TWO HUNDRED EIGHTEEN AND 20/100 DOLLARS (\$8,218.20) FROM UNAPPROPRIATED MONIES IN POLICE DEPARTMENT GRANT FUND (212) TO THE 212.000.50050 PD GRANT FUND CADET INTERNSHIP PROGRAM EXPENSE ACCOUNT AND DECLARING AN EMERGENCY.

WHEREAS, the City of Whitehall Division of Police was awarded a reimbursement grant for cadet internship in the amount of fourteen thousand and 00/100 dollars (\$14,000.00) in 2023 and;

WHEREAS, the City of Whitehall Division of Police paid five thousand seven hundred eighty-one and 80/100 dollars (\$5,781.80) to the cadets in 2023 and;

WHEREAS, the City of Whitehall Division Police needs to appropriate the remaining eight thousand two hundred eighteen and 20/00 dollars (\$8,218.20) to the expense account for 2024; NOW, THEREFORE,

BE IT ORDAINED BY THE COUNCIL OF THE CITY OF WHITEHALL, OHIO:

SECTION 1: The Council of the City of Whitehall, Ohio approves and makes a supplemental appropriation in the amount of eight thousand two hundred eighteen and 20/00 dollars (\$8,218.20) from unappropriated monies in the Police Department Grant Fund (212) to the PD Grant Fund Cadet Internship Program Expense Account 212.000.50050.

SECTION 2: That the City Auditor is hereby authorized to draw his warrant upon the Treasurer of the City for these funds for the purpose stated.

SECTION 3: That this Ordinance is hereby declared to be an emergency measure immediately necessary for the preservation of the public health, peace, safety and welfare of the community, and for further reason these funds need to be recorded into the appropriate grant fund account; WHEREFORE, this ordinance shall go into full force and effect immediately upon its passage and approval by the Mayor.

PASSED this ____ day of _____, 2024.

ATTEST:

Clerk of Council

President of Council

APPROVED this ____ day of _____, 2024.

Mayor

ORDINANCE NO. 003-2024

AUTHORIZING EXEMPTIONS OF 161.09(A) VACATION AND SICK LEAVE CREDIT CARRYOVER 161.09(8) FOR THE PURPOSE OF EMPLOYING A HIGHLY QUALIFIED EMPLOYEE TO THE CITY OF WHITEHALL AND DECLARING AN EMERGENCY.

WHEREAS, the City of Whitehall has the opportunity to hire a highly qualified individual as Director of Development in the Mayor's office; and

WHEREAS, the employee has valuable economic development and public finance experience with eighteen years of experience and the City would like to offer a match for service for computing vacation leave; NOW, THEREFORE,

BE IT ORDAINED BY THE COUNCIL OF THE CITY OF WHITEHALL, OHIO:

SECTION 1: The Council of the City of Whitehall, Ohio authorizes a one-time exemption for 161.09(A) to match years of service, and to match these years of service as indicated in 161.15(b)(l) of the Codified Ordinances of the City of Whitehall.

SECTION 2: That this Ordinance is hereby declared to be an emergency measure immediately necessary for the preservation of the public health, peace, safety and welfare; and for the further reason to permit this employee to carry over his years of service; WHEREFORE, This Ordinance shall go into full force and effect immediately upon its passage and approval by the Mayor.

PASSED this ____ day of _____, 2024.

ATTEST:

Clerk of Council

President of Council

APPROVED this ____ day of _____, 2024.

Mayor

ORDINANCE NO. 004-2024

AUTHORIZING EXEMPTIONS OF 161.09(A) VACATION AND SICK LEAVE CREDIT CARRYOVER 161.09(8) FOR THE PURPOSE OF EMPLOYING A HIGHLY QUALIFIED EMPLOYEE TO THE CITY OF WHITEHALL AND DECLARING AN EMERGENCY.

WHEREAS, the City of Whitehall has the opportunity to hire a highly qualified individual as Administrative Assistant to the Mayor in the Mayor's office; and

WHEREAS, the employee has valuable public service experience with nine years of experience and the City would like to offer a match for service for computing vacation leave; NOW, THEREFORE,

BE IT ORDAINED BY THE COUNCIL OF THE CITY OF WHITEHALL, OHIO:

SECTION 1: The Council of the City of Whitehall, Ohio authorizes a one-time exemption for 161.09(A) to match years of service, and to match these years of service as indicated in 161.15(b)(I) of the Codified Ordinances of the City of Whitehall.

SECTION 2: That this Ordinance is hereby declared to be an emergency measure immediately necessary for the preservation of the public health, peace, safety and welfare; and for the further reason to permit this employee to carry over her years of service; WHEREFORE, This Ordinance shall go into full force and effect immediately upon its passage and approval by the Mayor.

PASSED this ____ day of _____, 2024.

ATTEST:

Clerk of Council

President of Council

APPROVED this ____ day of _____, 2024.

Mayor

ORDINANCE NO. 005-2024

AMENDING SECTION 1103.02(C) (BUILDING PLACEMENT), AMENDING THE ZONING MAP ATTACHED TO CHAPTER 1104.01 OF THE 2023 CODIFIED ORDINANCES OF THE CITY OF WHITEHALL, OHIO AND AS SUBSEQUENTLY AMENDED, AND CHANGING THE ZONING ON PROPERTY LOCATED ON FAIRWAY BLVD., PARCEL NUMBERS 090-001774, 090-001812, 090-001819, 090-001775, 090-001776, 090-001010, 090-001777, 090-001735, 090-001778, 090-006752, 090-001780, 090-001781 and 090-001782, FROM STUR TO RESIDENTIAL ESTATE DISTRICT.

WHEREAS, Section 1103.02(c) (Building Placement) includes certain special provisions that are applicable to certain lots along Fairway Blvd., but does not include certain special provisions that were previously applicable to the Residential Estate District along Fairway Blvd. under a prior version of the Whitehall zoning code; and

WHEREAS, City Council has determined that it is desirable and in the best interests of the City to amend Section 1103.02(c) (Building Placement) to restore and enhance certain provisions regarding such Residential Estate District in order to protect and preserve the special and unique character of the Fairway Blvd. neighborhood; and

WHEREAS, this Ordinance was referred to the Planning Commission (Case No. _____), which reported _____ on said request; and

WHEREAS, Council has held a Public Hearing after due notice according to law; NOW, THEREFORE,

BE IT ORDAINED BY COUNCIL OF THE CITY OF WHITEHALL, OHIO:

SECTION 1: The Council of the City of Whitehall hereby approves the amendment of Section 1103.02(c) of its Codified Ordinances by adding the following provisions at the end of Section 1103.02(c) reestablishing the Residential Estate District:

Residential Estate District

The Residential Estate District shall include all lots on the east side of Fairway Blvd. beginning with 750 Fairway Blvd. and continuing south to and including 1000 Fairway Blvd. Parcel Numbers 090-001774, 090-001812, 090-001819, 090-001775, 090-001776, 090-001010, 090-001777, 090-001735, 090-001778, 090-006752, 090-001780, 090-001781 and 090-001782 (including, without limitation, any and all future lots resulting from lot splits thereof). The following special provisions, restrictions and limitations shall apply to the Residential Estate District:

(a) Purpose. The Residential Estate District is established to accommodate single-family residential dwellings at a density that will be similar to that which already exists in the area so defined. The objective in this district is to discourage large concentrations of intensive development where it is desirable to maintain the suburban character of the area. No additional public roads, areas or uses shall be permitted.

(b) Permitted Uses:

(1) Single-family residential dwellings.

(2) Accessory uses, provided such uses are incidental to the principal use and do not include any activity conducted as a business. Such uses must be situated on the same lot with the principal building.

(c) Special Permit Uses: The special permit uses are: Public utility rights of way.

(d) Area and Height Regulations: The area and height regulations are:

(1) Minimum lot area: 43,560 square feet.

(2) Minimum frontage: 200 feet.

(3) Minimum net floor area for living quarters: 3,000 square feet (foundation area, 1600 square feet minimum).

(4) Maximum building height: 40 feet.

(5) Minimum setback: 150 feet.

SECTION 2: That the Director of Public Service is hereby authorized and directed to proceed with the prescribed Ordinance directing the City Engineer to change the Official Zoning Map of the City of Whitehall.

ORDINANCE NO. 005-2024

SECTION 3: That this Ordinance shall go into full force and effect at the earliest date permitted by law.

PASSED this _____ day of _____, 2024.

ATTEST:

Clerk of Council

President of Council

APPROVED this _____ day of _____, 2024.

Mayor

ORDINANCE NO. 006-2024

AUTHORIZING AND APPROVING THE AMENDMENT OF 161.37(a) AND DECLARING AN EMERGENCY.

WHEREAS, given the nature of municipal government, the time required to manage the City, and the need for day to day management of city business, the City of Whitehall finds the needs of the City would be enhanced by creating the positions of Director of Public Service and Economic Development Director; NOW, THEREFORE,

BE IT ORDAINED BY THE COUNCIL OF THE CITY OF WHITEHALL, OHIO:

SECTION 1: The Table of Authorized Personnel 161.38(a) is amended to include the positions of Director of Public Service and Economic Development Director.

161.37 TABLE OF AUTHORIZED PERSONNEL.

The following legends shall apply to all tables delineating authorized strength:

Column	Name	Code
1	Position title	
2	Pay grade or salary pay range	SPR
3	Classified civil service	CCS
	Unclassified civil service	USC
4	Number authorized	
5	Union bargaining unit	UBU
	Exempt from union	EFU

(a) Office of the Mayor.

1	2	3	4	5
Administrative Assistant to the Mayor	SPR	UCS	1	EFU
Clerk of Court	SPR	CCS	1	EFU
Deputy Clerk of Courts	C-19	CCS	1	UBU
Director of Information Technology	SPR	UCS	1	EFU
System Administrator	SPR	UCS	1	EFU
Full-Time Information Technology Technician	SPR	UCS	2	EFU
Seasonal Intern	SPR	USC	1	EFU
Director of Public Service <i>this position is in place of City Administrator * per choice of Mayor</i>	<u>SPR</u>	<u>USC</u>	<u>1</u>	<u>EFU</u>
Economic Development Director <i>this position is in place of City Administrator * per choice of Mayor</i>	<u>SPR</u>	<u>USC</u>	<u>1</u>	<u>EFU</u>

ORDINANCE NO. 006-2024

SECTION 2: That this Ordinance is hereby declared to be an emergency measure immediately necessary for the preservation of the public health, peace, safety, and welfare and for the further reason the City desires to be more efficient in addressing the ever changing landscape of federal and state regulations in order to provide the best service to residents and businesses; WHEREFORE, this Ordinance shall go into full force and effect immediately upon its passage and approval by the Mayor.

PASSED this ____ day of _____, 2024.

ATTEST:

Clerk of Council

President of Council

APPROVED this ____ day of _____, 2024.

Mayor

RESOLUTION NO. 001-2024

AUTHORIZING THE MAYOR TO APPLY FOR AND ACCEPT ASSISTANCE FROM THE OHIO DEPARTMENT OF NATURAL RESOURCES VIA OHIO'S URBAN FORESTRY GRANT PROGRAM

WHEREAS, the Ohio Department of Natural Resources has reimbursable grants available from USDA Forest Service, from Inflation Reduction Act funding, intended to substantially invest in the long-term growth and development of local urban and community forestry programs; and

WHEREAS, the City of Whitehall desires to develop and execute a plan to protect its existing urban tree canopy and sustainably grow its public tree inventory; and

WHEREAS, the City of Whitehall desires to apply for and accept a reimbursable grant offered through the Ohio Department of Natural Resources in an amount not to exceed five hundred and fifty thousand and no/100 dollars (\$550,000); and

WHEREAS, the City of Whitehall is not required to provide any matching funds or in-kind services in order to accept said grant funding; NOW, THEREFORE,

BE IT RESOLVED BY THE COUNCIL OF THE CITY OF WHITEHALL, OHIO:

SECTION 1: That the Mayor is hereby authorized to apply for and accept an Ohio Urban Forestry Grant(s) in an amount not to exceed five hundred and fifty thousand and no/100 dollars (\$550,000).

SECTION 2: That the Mayor as Chief Executive Officer and Shannon Brady as Official Representative and Program Contact be directed and authorized to act in connection with the application.

SECTION 3: That this resolution shall take effect and be in force from the earliest period allowed by law.

PASSED this ____ day of _____, 2024.

ATTEST:

Clerk of Council

President of Council

APPROVED this ____ day of _____, 2024.

Mayor

RESOLUTION NO. 002-2024

A RESOLUTION TO ADOPT THE SOLID WASTE MANAGEMENT PLAN FOR THE SOLID WASTE AUTHORITY OF CENTRAL OHIO AND DECLARING AN EMERGENCY.

WHEREAS, the City of Whitehall (the "City") is located within the jurisdiction of the Solid Waste Authority of Central Ohio (SWACO); and

WHEREAS, the SWACO Board of Trustees prepared and adopted a final draft of the Solid Waste Management Plan in accordance with Ohio Revised Code Sections 3734.53, 3734.54, 3734.55 and 3734.56 on December 12, 2023; and

WHEREAS, SWACO has provided a copy of the Draft Final Solid Waste Management Plan for ratification to each of the legislative authorities of the District; and

WHEREAS, the City of Whitehall must decide whether is approves of said Solid Waste Management Plan within ninety days of receipt of the Final Draft Plan; and NOW, THEREFORE,

BE IT RESOLVED by the Council of the City of Whitehall, Franklin County, State of Ohio, __ of the elected members concurring that:

SECTION 1: The City approves the SWACO Solid Waste Management Plan.

SECTION 2: The Clerk is hereby directed to send SWACO a copy of this resolution to the attention of Andrew Booker, SWACO, 4239 London Groveport Rd., Grove City, OH 43123 or by email Andrew.booker@swaco.org.

SECTION 3: That is found and determined that all formal actions of the Council of the City of Whitehall, Franklin County, State of Ohio concerning and relating to the passage of this resolution were adopted in an open meeting of this Council and of any of its committees that resulted in such formal actions were in meetings open to the public in compliance with all legal requirements including Sections 121.22 of the Ohio Revised Code.

PASSED this ____ day of _____, 2024.

ATTEST:

Clerk of Council

President of Council

APPROVED this ____ day of _____, 2024 _____
Mayor